



CMR1U-01M  
 CMR1U-02M  
 CMR1U-04M  
 CMR1U-06M

**ULTRA FAST RECOVERY RECTIFIER  
 1.0 AMP, 100 THRU 600 VOLTS**

**SUPER  
 mini**



**SMA CASE**

**Central**<sup>TM</sup>  
 Semiconductor Corp.

**FEATURES:**

- SUPER MINIATURE CASE
- SPECIAL SELECTIONS AVAILABLE
- LOW COST
- SUPERIOR LOT TO LOT CONSISTENCY
- HIGH RELIABILITY
- "C" BEND CONSTRUCTION PROVIDES STRAIN
- GLASS PASSIVATED CHIP RELIEF WHEN MOUNTED ON PC BOARD

**DESCRIPTION:**

The CENTRAL SEMICONDUCTOR 1.0 Amp Surface Mount Ultra Fast Recovery Silicon Rectifier is a high quality, well constructed, highly reliable component designed for use in all types of commercial, industrial, entertainment, computer, and automotive applications where small size is required. The SMA case occupies 30% less board space than the SMB case. To order devices on 12mm Tape and Reel (5000/13" Reel), add TR13 suffix to part number.

**MAXIMUM RATINGS:** ( $T_A=25^{\circ}\text{C}$  unless otherwise noted)

	SYMBOL	CMR1U -01M	CMR1U -02M	CMR1U -04M	CMR1U -06M	UNITS
Peak Repetitive Reverse Voltage	$V_{RRM}$	100	200	400	600	V
DC Blocking Voltage	$V_R$	100	200	400	600	V
RMS Reverse Voltage	$V_{R(RMS)}$	70	140	280	420	V
Average Forward Current( $T_A=75^{\circ}\text{C}$ )	$I_O$			1.0		A
Peak Forward Surge Current (8.3ms)	$I_{FSM}$			30		A
Operating and Storage						
Junction Temperature	$T_J, T_{stg}$		-65 to +175			$^{\circ}\text{C}$
Thermal Resistance	$\theta_{JL}$		30			$^{\circ}\text{C/W}$

**ELECTRICAL CHARACTERISTICS:** ( $T_A=25^{\circ}\text{C}$  unless otherwise noted)

SYMBOL	TEST CONDITIONS	MIN	MAX	UNITS
$I_R$	$V_R$ =Rated $V_{RRM}$		5.0	$\mu\text{A}$
$V_F$	$I_F=1.0\text{A}$ , (CMR1U-01M, CMR1U-02M)		1.00	V
$V_F$	$I_F=1.0\text{A}$ , (CMR1U-04M)		1.25	V
$V_F$	$I_F=1.0\text{A}$ , (CMR1U-06M)		1.40	V
$t_{rr}$	$I_F=0.5\text{A}$ , $I_R=1.0\text{A}$ , Recover to 0.25A (CMR1U-01M, -02M)		35	ns
$t_{rr}$	$I_F=0.5\text{A}$ , $I_R=1.0\text{A}$ , Recover to 0.25A (CMR1U-04M)		50	ns
$t_{rr}$	$I_F=0.5\text{A}$ , $I_R=1.0\text{A}$ , Recover to 0.25A (CMR1U-06M)		75	ns

All dimensions in inches (mm).

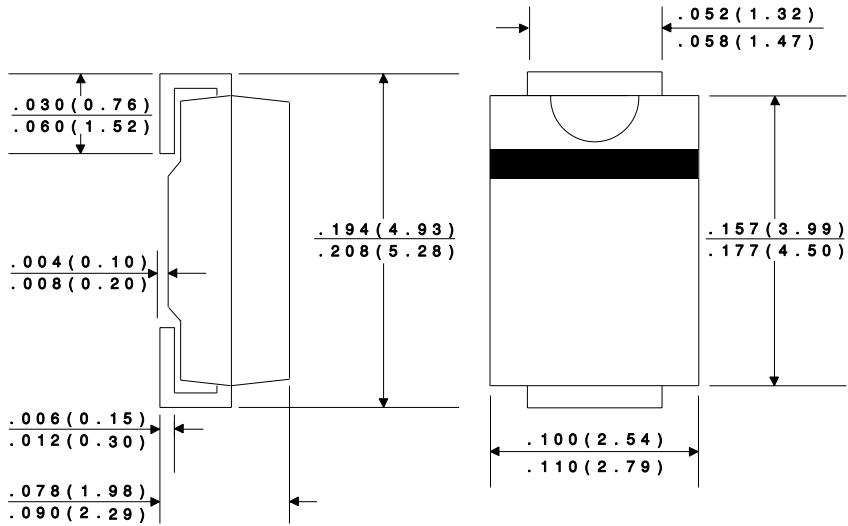

**Marking Codes:**

DEVICE	MARKING CODE
CMR1U-01M	CU01M
CMR1U-02M	CU02M
CMR1U-04M	CU04M
CMR1U-06M	CU06M